

ZHUZHOU BETTER TUNGSTEN CARBIDE CO.,LIMITED

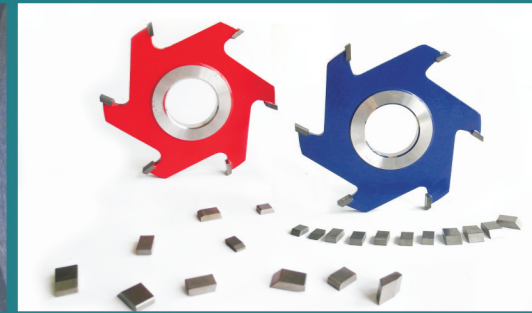

**WOODWORKING TOOLS**  
Solution for Woodworking Industry

Full range of types in GB, ISO, USA standard and non-standard



电话: 0086-731-28705418

传真: 0086-731-28510897

网址: www.zzbetter.com

邮箱: sales@zzbetter.com; socarbide@aliyun.com

地址: 中国·湖南省株洲市天元区黄河北路

Tel: 0086-731-28705418

Fax: 0086-731-28510897

Web site: www.zzbetter.com

MAIL: sales@zzbetter.com; socarbide@aliyun.com

ADD: Huanghe North Road, Tianyuan District,  
Zhuzhou City, Hunan Province, China. 412000

FACE BOOK: linda9638@hotmail.com



**株洲贝特**  
zzbetter.com

**株洲贝特硬质合金工具有限公司**

ZHUZHOU BETTER TUNGSTEN CARBIDE CO., LIMITED





### Spray Drying

Spray drying process is in a totally enclosed environment, with the protective of high purity nitrogen to spray and drying the mixed material. Advantages: uniform density, precise size control, small single fluctuation.

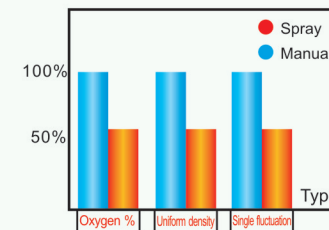

### CIP Process

CIP process is in normal temperature environment, use high pressure make the material shaped, by using rubber or plastic as outer covering and liquid as pressure medium. Advantages: to eliminate the internal defects, make sure uniform density.

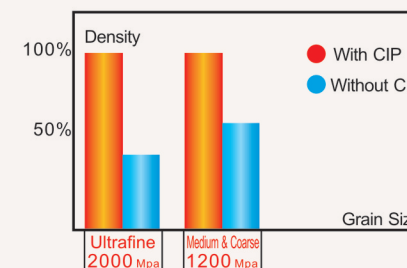

### HIP Process

HIP sintering is in the environment with inactive gas, use high temperature and high pressure to avoid internal pores. Advantages: make products in better compactness, higher hardness and strength.

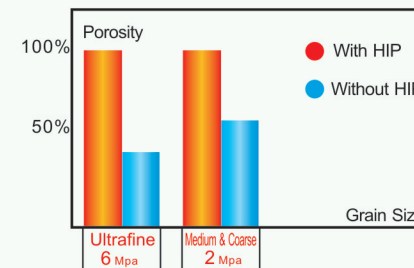

### Stress Treatment

It includes three procedures: sub-zero treatment, vibration treatment, and heat treatment. During the procedures, our carbide products' microstructure improved, stress relieved, and comprehensive properties got better. Thus the products get a longer life time.

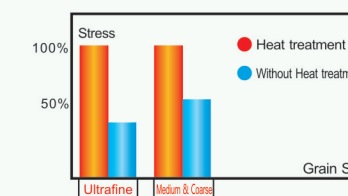
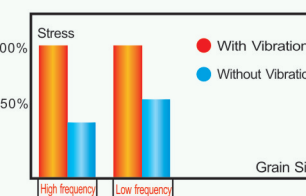
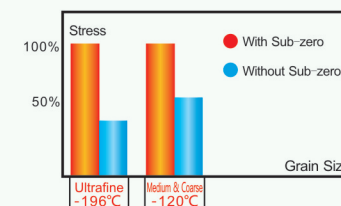

株洲贝特  
zzbetter.com

株洲贝特硬质合金工具有限公司  
ZHUSHOU BETTER TUNGSTEN CARBIDE CO., LIMITED



### Carbide STB Strips in USA Standard

Tolerance: L: +0 ~ +0.10", W: +0 ~ +0.01", T: +0 ~ +0.01"

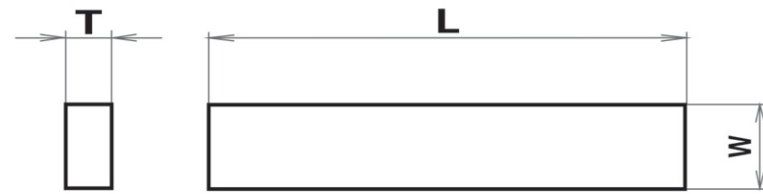

Type	Dimensions ( inch ")		
	L	W	T
STB 210	6	5/16	1/16
STB 212	6	3/8	1/17
STB 216	6	1/2	1/18
STB 220	6	5/8	1/19
STB 224	6	3/4	1/20
STB 228	6	7/8	1/21
STB 232	6	1	1/22
STB 240	6	1 1/4	1/23
STB 248	6	1 1/2	1/24
STB 26C	6	3/16	1/25
STB 28	6	1/4	1/26
STB 28A	1	1/5	1/27
STB 28B	1 1/4	1/6	1/28
STB 28D	3	1/7	1/29

Type	Dimensions ( inch ")		
	L	W	T
STB 310	6	5/16	3/32
STB 312	6	3/8	3/33
STB 312A	6	3/8	3/34
STB 316	6	1/2	3/35
STB 320	6	5/8	3/36
STB 324	6	3/4	3/37
STB 328	6	7/8	3/38
STB 332	6	1	3/39
STB 336	6	1 1/8	3/40
STB 340	6	1 1/4	3/41
STB 344	6	1 3/8	3/42
STB 348	6	1 1/2	3/43
STB 356	6	1 3/4	3/44
STB 36	6	3/16	3/45
STB 364	6	2	3/46
STB 38E	6	1/4	3/47

Grade	ISO Code	Hardness (HRA)	T.R.S. (MPa)
C1	K10	91.5	2000
C2	K20	90.5	2400
C3	K30	91.5	2600

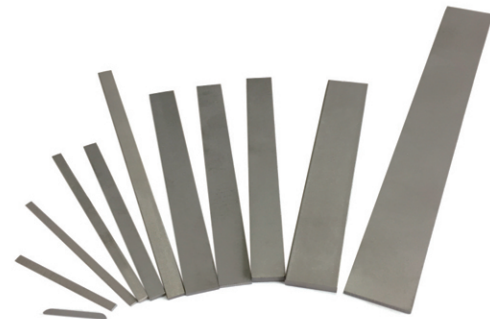

### Carbide STB Strips in USA Standard

Tolerance: L: +0 ~ +0.10", W: +0 ~ +0.01", T: +0 ~ +0.01"

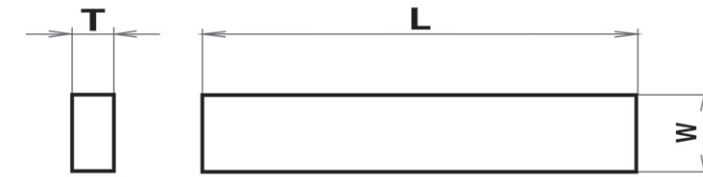

Type	Dimensions ( inch ")		
	L	W	T
STB 410	6	5/16	1/8
STB 412C	6	3/8	1/8
STB 412D	1	3/8	1/8
STB 416	6	1/2	1/8
STB 416A	1	1/2	1/8
STB 416B	1 1/2	1/2	1/8
STB 420	5/8	1/2	1/8
STB 424	3	5/8	1/8
STB 424A	6	3/4	1/8
STB 428	6	3/4	1/8
STB 432	1	7/8	1/8
STB 440	6	1	1/8
STB 444	6	1 1/4	1/8
STB 448	6	1 3/8	1/8
STB 456	6	1 1/2	1/8
STB 48A	1	1 3/4	1/8
STB 48E	8	1/4	1/8

Type	Dimensions ( inch ")		
	L	W	T
STB 510	6	5/16	5/32
STB 512	6	3/8	5/32
STB 516	6	1/2	5/32
STB 520	6	5/8	5/32
STB 524	6	3/4	5/32
STB 528	6	7/8	5/32
STB 532	6	1	5/32
STB 536	6	1 1/8	5/32
STB 540	6	1 1/4	5/32
STB 548	6	1 1/2	5/32
STB 556	6	1 3/4	5/32
STB 564	6	2	5/32

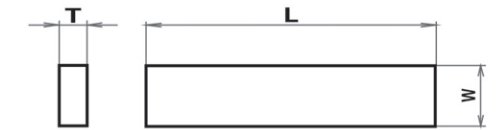

Type	Dimensions ( inch ")		
	L	W	T
STB 612	6	2/8	3/16
STB 616	6	1/2	3/16
STB 620	6	5/8	3/16
STB 624	6	3/4	3/16
STB 628	6	7/8	3/16
STB 632	6	1	3/16
STB 632	6	1 1/8	3/16
STB 636	6	1 1/4	3/16
STB 640	6	1 1/4	3/16
STB 644	6	1 3/8	3/16
STB 648	6	1 1/2	3/16
STB 656	6	1 3/4	3/16

Type	Dimensions ( inch ")		
	L	W	T
STB 812	6	3/8	1/4
STB 816	6	1/2	1/4
STB 820	6	5/8	1/4
STB 824	6	3/4	1/4
STB 832	6	1	1/4
STB 840	6	1 1/4	1/4

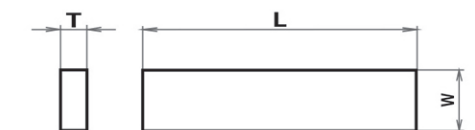

Zhuzhou Better Tungsten Carbide Co., Ltd

Tel: +86 731 28705418

Website: www.zzbetter.com

Email: sales@zzbetter.com; sales7@zzbetter.com

Skype: zzmrc

Whatsapp: +86 13647338188

Facebook: linda9638@hotmail.com



## Carbide Flat Strips

With high quality raw material and advanced equipment, Zzbetter provides customer superior quality carbide strips.

- ◆ Easy to be brazed, good wear resistance and toughness.
- ◆ Ultrafine grain size raw material to keep excellent strength and hardness.
- ◆ Both standard sizes and customizes sizes are available.



ZZBT Grade	ISO Grade	Density (g/cm <sup>3</sup> )	Hardness (HRA)	T.R.S (MPα)	Grain Size	Performance & Application Recommended
UBT910	K20	14.6-15.0	90~90.5	2200~2400	Medium	High hardness, suitable for roughing of iron, solid wood, dry wood or nonferrous metal, ceramic and other alloys.
UBT40S	K25	14.6-15.0	90~90.5	2600~2800	Fine	High toughness, easy to be brazed without heat preservation. Suitable for rosewood, solid wood, pinewood, and other wood with a lot stammer.
UBT920	K10~K15	14.6-15.0	91~91.8	2400~2600	Fine	Good versatility, suitable for kinds of solid wood, rosewood, and MDF.
UBT15T	K10~K15	14.6-15.0	92.5~93	2000~2200	Ultrafine	High hardness, suitable for finishing of iron, nonferrous metal, ceramic and other alloying, semifinishing of of hardwood, chipboard, MDF and HDF. Heat preservation is necessary when brazing.
UBT10T	K10	14.6-15.0	92.5~93	1800-2000	Ultrafine	High hardness, suitable for finishing of iron, nonferrous metal, ceramic and other alloying, semifinishing of of hardwood, chipboard, MDF and HDF. Better to use silver soldering.
UBT10C	K40	13.8-14.2	87.5~88	2800~3000	Coarse	High toughness, difficult to break tooth. Special used for finger jointing tool.



## Carbide Flat Strips

Type	T*W*L (mm)	T (mm)	W (mm)	L (mm)
FS05	T x 5 x 320	2.0~15.0	5	320
FS06	T x 6 x 320	2.0~15.0	6	320
FS07	T x 7 x 320	2.0~15.0	7	320
FS08	T x 8 x 320	2.0~15.0	8	320
FS09	T x 9 x 320	2.0~15.0	9	320
FS10	T x 10 x 320	2.0~15.0	10	320
FS11	T x 11 x 320	2.0~15.0	11	320
FS12	T x 12 x 320	2.0~15.0	12	320
FS13	T x 13 x 320	2.0~15.0	13	320
FS14	T x 14 x 320	2.0~15.0	14	320
FS15	T x 15 x 320	2.0~15.0	15	320
FS16	T x 16 x 320	2.0~15.0	16	320
FS17	T x 17 x 320	2.0~15.0	17	320
FS18	T x 18 x 320	2.0~15.0	18	320
FS19	T x 19 x 320	2.0~15.0	19	320
FS20	T x 20 x 320	2.0~15.0	20	320
FS22	T x 22 x 320	2.0~15.0	22	320
FS25	T x 25 x 320	2.0~15.0	25	320
FS28	T x 28 x 320	2.0~15.0	28	320
FS30	T x 30 x 320	2.0~15.0	30	320
FS32	T x 32 x 320	2.0~15.0	32	320
FS35	T x 35 x 320	2.0~15.0	35	320
FS40	T x 40 x 320	2.0~15.0	40	320
FS45	T x 45 x 320	2.0~15.0	45	320
FS50	T x 50 x 320	2.0~15.0	50	320
FS55	T x 55 x 320	2.0~15.0	55	320



Type FS series

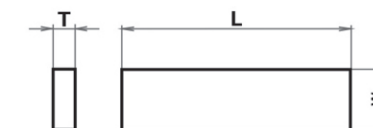

Tolerance (mm)		
L	>150	-0~+L*2%
W	≤8.0	-0~+0.35
	8.0~25.0	-0~+0.50
	25.0~35.0	-0~+0.70
	>35.0	-0~+1.20
T	≤15.0	-0~+0.40

Flatness (mm)		
W	≤20.0	≤0.50
	>20.0	≤0.60

※ Please contact us for special sizes and minimum order quantity.

**Zhuzhou Better Tungsten Carbide Co., Ltd**

Tel: +86 731 28705418

Website: www.zzbetter.com

Email: sales@zzbetter.com; sales7@zzbetter.com

Skype: zzmrc

Whatsapp: +86 13647338188

Facebook: linda9638@hotmail.com



## Carbide Strips with Bevel Angles

With high quality raw material and advanced equipment, Zzbetter provides customer superior quality carbide strips.

- ◆ Easy to be brazed, good wear resistance and toughness.
- ◆ Ultrafine grain size raw material to keep excellent strength and hardness.
- ◆ Both standard sizes and customizes sizes are available.



ZZBT Grade	ISO Grade	Density (g/cm <sup>3</sup> )	Hardness (HRA)	T.R.S (MPa)	Grain Size	Performance & Application Recommended
UBT910	K20	14.6-15.0	90~90.5	2200~2400	Medium	High hardness, suitable for roughing of iron solid wood, dry wood or nonferrous metal, ceramic and other alloys.
UBT40S	K25	14.6-15.0	90~90.5	2600~2800	Fine	High toughness, easy to be brazed without heat preservation. Suitable for rosewood, solid wood, pinewood, and other wood with a lot stammer.
UBT920	K10~K15	14.6-15.0	91~91.8	2400~2600	Fine	Good versatility, suitable for kinds of solid wood, rosewood, and MDF.
UBT15T	K10~K15	14.6-15.0	92.5~93	2000~2200	Ultrafine	High hardness, suitable for finishing of iron, nonferrous metal, ceramic and other alloying, semifinishing of of hardwood, chipboard, MDF and HDF. Heat preservation is necessary when brazing.
UBT10T	K10	14.6-15.0	92.5~93	1800-2000	Ultrafine	High hardness, suitable for finishing of iron, nonferrous metal, ceramic and other alloying, semifinishing of of hardwood, chipboard, MDF and HDF. Better to use silver soldering.
UBT10C	K40	13.8-14.2	87.5~88	2800~3000	Coarse	High toughness, difficult to break tooth. Special used for finger jointing tool.

## Carbide Strips with Bevel Angles

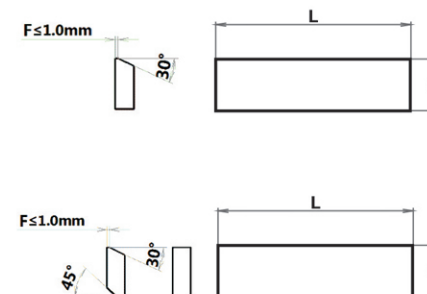

Tolerance (mm)		
L	>150	-0~+L*2%
W	≤8.0	-0~+0.35
	8.0~25.0	-0~+0.50
	25.0~35.0	-0~+0.70
	>35.0	-0~+1.20
T	≤15.0	-0~+0.40

Flatness (mm)		
W	≤20.0	≤0.50
	20.0~40.0	≤0.60

Type	T*W*L (mm)	T (mm)	W (mm)	L (mm)
SSB/SDB 05	T x 5 x 320	2.0~15.0	5	320
SSB/SDB 06	T x 6 x 320	2.0~15.0	6	320
SSB/SDB 07	T x 7 x 320	2.0~15.0	7	320
SSB/SDB 08	T x 8 x 320	2.0~15.0	8	320
SSB/SDB 09	T x 9 x 320	2.0~15.0	9	320
SSB/SDB 10	T x 10 x 320	2.0~15.0	10	320
SSB/SDB 11	T x 11 x 320	2.0~15.0	11	320
SSB/SDB 12	T x 12 x 320	2.0~15.0	12	320
SSB/SDB 13	T x 13 x 320	2.0~15.0	13	320
SSB/SDB 14	T x 14 x 320	2.0~15.0	14	320
SSB/SDB 15	T x 15 x 320	2.0~15.0	15	320
SSB/SDB 16	T x 16 x 320	2.0~15.0	16	320
SSB/SDB 17	T x 17 x 320	2.0~15.0	17	320
SSB/SDB 18	T x 18 x 320	2.0~15.0	18	320
SSB/SDB 19	T x 19 x 320	2.0~15.0	19	320
SSB/SDB 20	T x 20 x 320	2.0~15.0	20	320
SSB/SDB 22	T x 22 x 320	2.0~15.0	22	320
SSB/SDB 25	T x 25 x 320	2.0~15.0	25	320
SSB/SDB 28	T x 28 x 320	2.0~15.0	28	320
SSB/SDB 30	T x 30 x 320	2.0~15.0	30	320
SSB/SDB 32	T x 32 x 320	2.0~15.0	32	320
SSB/SDB 35	T x 35 x 320	2.0~15.0	35	320
SSB/SDB 40	T x 40 x 320	2.0~15.0	40	320
SSB/SDB 45	T x 45 x 320	2.0~15.0	45	320
SSB/SDB 50	T x 50 x 320	2.0~15.0	50	320
SSB/SDB 55	T x 55 x 320	2.0~15.0	55	320

※ Please contact us for special sizes and minimum order quantity.

### Zhuzhou Better Tungsten Carbide Co., Ltd

Tel: +86 731 28705418

Website: www.zzbetter.com

Email: sales@zzbetter.com; sales7@zzbetter.com

Skype: zzmrc

Whatsapp: +86 13647338188

Facebook: linda9638@hotmail.com



## Woodworking Saw Tips

Grades, properties and application recommended



Grade	Binder %	Density (g/cm <sup>3</sup> )	HRA	HV10	HV30	Mpa	Code ISO	Code USA	Application recommended
UBT103	6	14.95	92.5	1730	1700	2100	K10	C3	With good wear resistance, apply to density board, solid wood working.
UBT107	6	14.95	91.0	1490	1470	2300	K25	C2	Welding performance is good, mainly used for solid wood working.
UBT203	4	15.15	93.2	1860	1830	2400	K01	C3-C4	Superfine grain, high wear resistance, apply to density board.
UBT205	5.5	14.95	92.7	1760	1730	2500	K05	C3	For hardwood, MDF and Aluminum.
UBT210	10	14.55	91.2	1520	1500	2500	K30	C1	For soft wood.
UBT211	5.5	15	91.9	1620	1590	2200	K20	C2~C3	For used wood.
UBT405	3.3	15.2	93.6	1950	1910	2500	-	-	Superfine grain size, high wear resistance, a special design for binding phase resists to corrosion, apply to density board, veneer board and chipboard.
UBT406	3	15.25	93.8	2000	1980	2500	-	-	Ultra-fine grain size, high wear resistance, a special design for binding phase resists to corrosion, perfect for cutting chipboard.
UBT615	7	14.8	92	1700	1680	2700	K10	-	Versatility is good, apply to density board and solid wood.
UBT008	3.5	15.2	93.5	1930	1900	2500	k01		For hardwood and rosewood.
UBT006	3.2	15.25	93.7	2000	1980	2500	K01		For rosewood cutting

## USA Standard Style Woodworking Saw Tips

Style	L (inch")	W (inch")	T (inch")
WBC7100~7120	0.821	0.100~0.120	0.078
WBC7125~7312	0.312	0.125~0.312	0.093
WEC7150~7375	0.375	0.150~0.375	0.093
WFC7140~7687	0.500	0.140~0.687	0.125
WGC7150~7312	0.375	0.150~0.312	0.125
WHC7110~7300	0.344	0.110~0.300	0.125

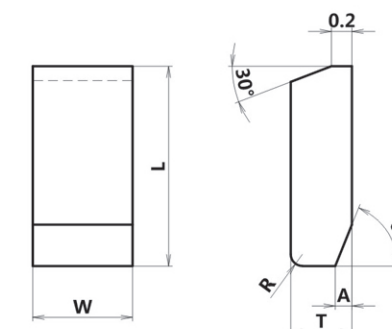

Style	L (inch")	W (inch")	T (inch")
WA7065~7125	0.250	0.065~0.215	0.062
WB7085~7312	0.281	0.085~0.312	0.078
WC7100~7250	0.281	0.100~0.250	0.093
WD7100~7312	0.312	0.100~0.312	0.093
WE7150~7375	0.375	0.150~0.375	0.093
WF7150~7750	0.500	0.150~.75	0.125
WG7150~7750	0.375	0.150~0.750	0.125
WH7125~7300	0.344	0.125~0.300	0.125
WQ7170~7375	0.375	0.170~0.375	0.156

Style	L (inch")	W (inch")	T (inch")
WA8065~8125	0.250	0.065~0.215	0.062
WB8085~8312	0.281	0.085~0.312	0.078
WC8100~8250	0.281	0.100~0.250	0.093
WD8100~8312	0.312	0.100~0.312	0.093
WE8150~8375	0.375	0.150~0.375	0.093
WF8150~8750	0.500	0.150~.75	0.125
WG8150~8750	0.375	0.150~0.750	0.125
WH8125~8300	0.344	0.125~0.300	0.125
WQ8170~8375	0.375	0.170~0.375	0.156

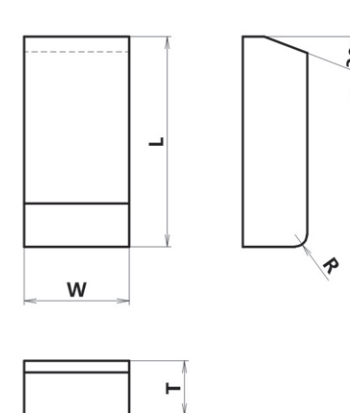

Style:7000

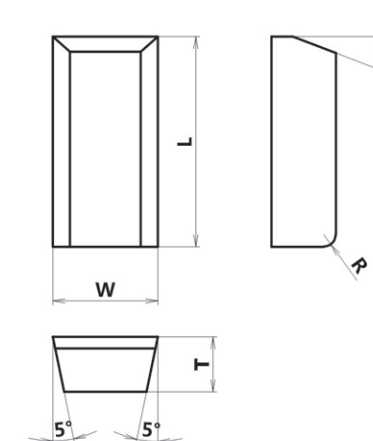

Style:8000



## Woodworking Saw Tips

Grades, properties and application recommended



Grade	Binder %	Density (g/cm <sup>3</sup> )	HRA	HV10	HV30	Mpa	Code ISO	Code USA	Application recommended
UBT103	6	14.95	92.5	1730	1700	2100	K10	C3	With good wear resistance, apply to density board, solid wood working.
UBT107	6	14.95	91.0	1490	1470	2300	K25	C2	Welding performance is good, mainly used for solid wood working.
UBT203	4	15.15	93.2	1860	1830	2400	K01	C3-C4	Superfine grain, high wear resistance, apply to density board.
UBT205	5.5	14.95	92.7	1760	1730	2500	K05	C3	For hardwood, MDF and Aluminum.
UBT210	10	14.55	91.2	1520	1500	2500	K30	C1	For soft wood.
UBT211	5.5	15	91.9	1620	1590	2200	K20	C2~C3	For used wood.
UBT405	3.3	15.2	93.6	1950	1910	2500	-	-	Superfine grain size, high wear resistance, a special design for binding phase resists to corrosion, apply to density board, veneer board and chipboard.
UBT406	3	15.25	93.8	2000	1980	2500	-	-	Ultra-fine grain size, high wear resistance, a special design for binding phase resists to corrosion, perfect for cutting chipboard.
UBT615	7	14.8	92	1700	1680	2700	K10	-	Versatility is good, apply to density board and solid wood.
UBT008	3.5	15.2	93.5	1930	1900	2500	k01	-	For hardwood and rosewood.
UBT006	3.2	15.25	93.7	2000	1980	2500	K01	-	For rosewood cutting

## EUR Standard Style Woodworking Saw Tips

Style	L	W	T	C	a <sup>1</sup>	β	R	Style	L	W	T	C	a <sup>1</sup>	β	R
A/B 5015-1.3~3.5	5.0	1.3~3.5	1.5	0.4	15.0	15	0.4	A/B 8525-1.8~5.0	8.5	1.8~5.0	2.5	1.1	30	70	0.5
A/B 5016-1.3~3.5	5.0	1.3~3.5	1.6	0.5	15.0	15	0.4	A/B 8528-1.8~5.1	8.5	1.8~5.0	2.8	1.1	30	70	0.5
A/B 5515-1.3~3.5	5.5	1.3~3.5	1.5	0.5	15.0	15	0.4	A/B 9025-2.0~6.0	9.0	2.0~6.0	2.5	1.1	30	70	0.5
A/B 5517-1.3~3.5	5.5	1.3~3.5	1.7	0.5	15.0	15	0.4	A/B 9028-2.0~6.0	9.0	2.0~6.0	2.8	1.1	30	70	0.5
A/B 6018-1.5~4.0	6.0	1.5~4.0	1.8	0.6	15.0	15	0.5	A/B 9030-2.0~6.0	9	2.0~6.0	3.0	1.5	30	60	0.5
A/B 6020-1.5~4.0	6.0	1.5~4.0	2.0	0.7	20.0	20	0.5	A/B 9525-2.0~6.0	9.5	2.0~6.0	2.5	1.1	30	60	0.5
A/B 6518-1.5~4.0	6.5	1.5~4.0	1.8	0.7	20.0	20	0.5	A/B 9528-2.0~6.0	9.5	2.0~6.0	2.8	1.1	30	70	0.5
A/B 6520-1.5~4.0	6.5	1.5~4.0	2.0	0.7	20.0	20	0.5	A/B 9530-2.0~6.0	9.5	2.0~6.0	3.0	1.5	30	70	0.5
A/B 6523-1.5~4.0	6.5	1.5~4.0	2.3	0.9	25.0	25	0.5	A/B 10024-2.0~6.0	10.0	2.0~6.0	2.4	1.1	30	70	0.5
A/B 7023-1.5~4.0	7.0	1.5~4.0	2.3	0.9	25.0	25	0.5	A/B 10028-2.0~6.0	10.0	2.0~6.0	2.8	1.1	30	70	0.5
A/B 7025-1.5~4.0	7.0	1.5~4.0	2.5	1.1	1.1	30	0.5	A/B 10525-2.0~7.0	10.5	2.0~7.0	2.5	1.1	30	70	0.5
A/B 7523-1.5~4.0	7.5	1.5~4.0	2.3	0.9	0.9	30	0.5	A/B 10528-3.0~10.0	10.5	3.0~10.0	2.8	1.1	30	70	0.5
A/B 7525-1.5~4.0	7.5	1.5~4.0	2.5	1.1	1.1	30	0.5	A/B 10530-3.0~10.0	10.5	3.0~10.0	3.0	1.5	30	70	0.5
A/B 8020-1.8~4.5	8.0	1.8~4.5	2.0	0.7	0.7	20	0.5	A/B 10535-3.0~10.0	10.5	3.0~10.0	3.5	1.5	30	70	0.5
A/B 8023-1.8~4.5	8.0	1.8~4.5	2.3	0.9	0.9	25	0.5	A/B 12535-3.0~10.0	12.5	3.0~10.0	3.5	1.5	30	70	0.5
A/B 8025-1.8~4.5	8.0	1.8~4.5	2.5	1.1	1.1	30	0.5	A/B 13040-3.0~10.0	13.5	3.0~10.0	4.0	2.0	30	70	0.5

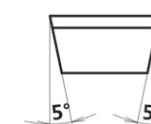
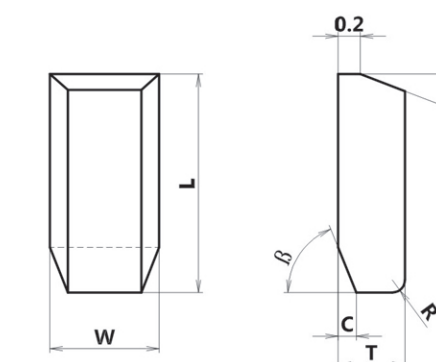
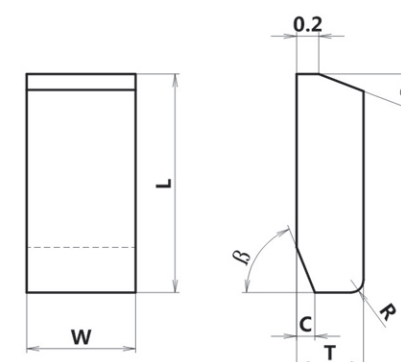

Style:A

Style:B

Zhuzhou Better Tungsten Carbide Co., Ltd

Tel: +86 731 28705418

Website: www.zzbetter.com

Email: sales@zzbetter.com; sales7@zzbetter.com

Skype: zzmrc

Whatsapp: +86 13647338188

Facebook: linda9638@hotmail.com



## Carbide Indexable Inserts

Equipped with a number of precise periphery grinders and surface grinders, our indexable inserts are featured of sharp edge, tight tolerance and bright surface. Especially, the micro-grain grades can remarkably improve the speed and precision of woodworking planer and millers.

Dimensions (mm)	L (mm)	W (mm)	T (mm)	D (mm)
7.5 X 12.0 X 1.5 - $\phi$ 4.0	7.5	12.0	1.5	4.0
8.6 X 12.0 X 1.5 - $\phi$ 4.0	8.6	12.0	1.5	4.0
9.6 X 12.0 X 1.5 - $\phi$ 4.0	9.6	12.0	1.5	4.0
10.5 X 10.5 X 1.5 - $\phi$ 4.0	10.5	12.0	1.5	4.0
15.0 X 12.0 X 1.5 - $\phi$ 4.0	15.0	12.0	1.5	4.0
20.0 X 12.0 X 1.5 - $\phi$ 4.0	20.0	12.0	1.5	4.0

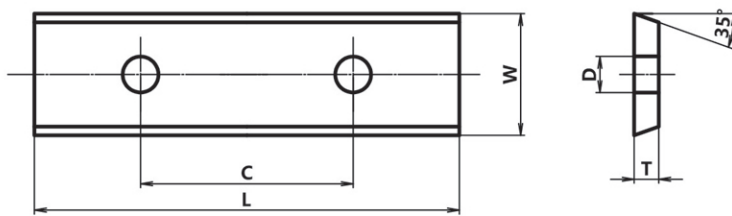
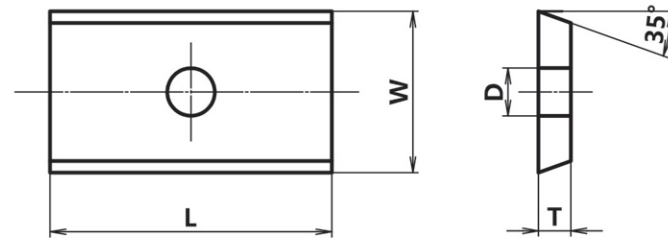

Dimensions (mm)	L (mm)	W (mm)	T (mm)	D (mm)	C (mm)
25.0 x 12.0 x 1.5 - $\phi$ 4.0	25	12.0	1.5	4.0	14.0
30.0 x 12.0 x 1.5 - $\phi$ 4.0	30	12.0	1.5	4.0	14.0
40.0 x 12.0 x 1.5 - $\phi$ 4.0	40	12.0	1.5	4.0	26.0
50.0 x 12.0 x 1.5 - $\phi$ 4.0	50	12.0	1.5	4.0	26.0
60.0 x 12.0 x 1.5 - $\phi$ 4.0	60	12.0	1.5	4.0	26.0

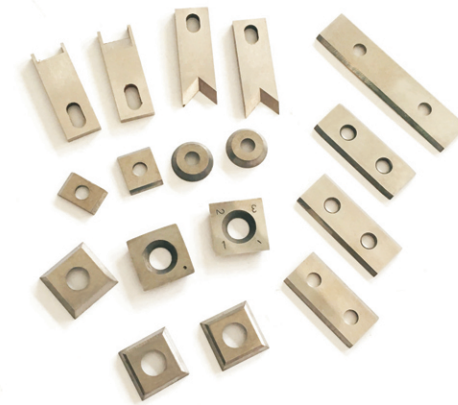

Dimensions (mm)	L (mm)	W (mm)	T (mm)	D (mm)
18.0 X 18.0 X 1.9-10.3	18.0	18.0	1.9	10.3
18.0 X 18.0 X 2.9-10.3	18.0	18.0	2.9	11.3
18.0 X 18.0 X 4.0-10.3	18.0	18.0	4.0	12.3
18.0 X 18.0 X 5.0-10.3	18.0	18.0	5.5	13.3

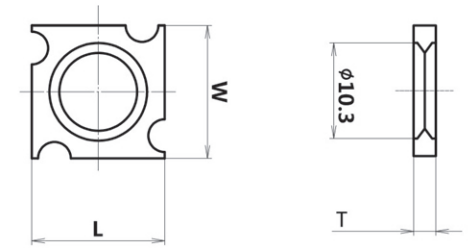

Dimensions (mm)	L (mm)	W (mm)	T (mm)	D (mm)
22.0 X 19.0 X 2.0 - $\phi$ 6.5	22	19.0	2.0	6.5

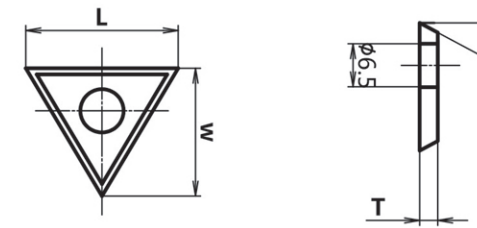

Dimensions (mm)	L (mm)	W (mm)	T (mm)	D (mm)
29.5 X 12.0 X 1.5- 4.0	29.5	12.0	1.5	4.0
39.5 X 12.0 X 1.5- 4.0	39.5	12.0	1.5	4.0
49.5 X 12.0 X 1.5- 4.0	49.5	12.0	1.5	4.0
59.5 X 12.0 X 1.5- 4.0	59.5	12.0	1.5	4.0

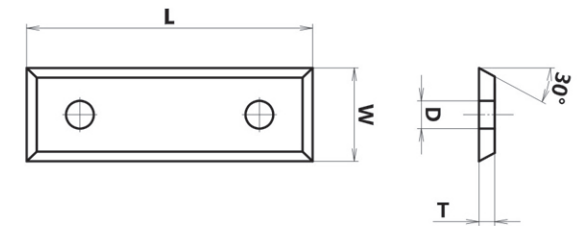

Dimensions (mm)	L (mm)	W (mm)	T (mm)	D (mm)
14.0 X 14.0 X 1.2 - $\phi$ 8.35	14	14.0	1.2	8.4
14.0 X 14.0 X 2.0 - $\phi$ 6.36	14	14.0	2.0	6.4

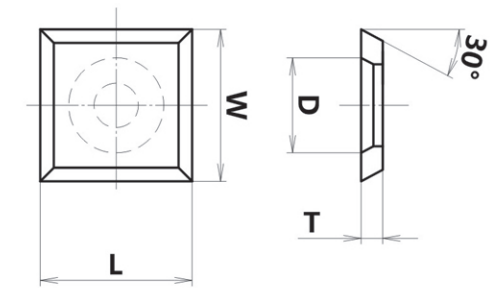

Dimensions (mm)	L (mm)	W (mm)	T (mm)	D (mm)
12.0 X 12.0 X 1.5 - $\phi$ 4.0	12.0	12.0	1.5	4.0
17.0 X 17.0 X 2.0 - $\phi$ 4.0	17.0	17.0	2.0	4.0
19.0 X 19.0 X 2.0 - $\phi$ 4.0	19.0	19.0	2.0	4.0

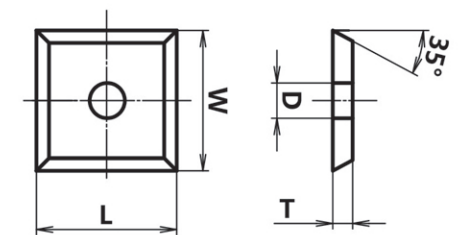

Zhuzhou Better Tungsten Carbide Co., Ltd

Tel: +86 731 28705418

Website: www.zzbetter.com

Email: sales@zzbetter.com; sales7@zzbetter.com

Skype: zzmrc

Whatsapp: +86 13647338188

Facebook: linda9638@hotmail.com



### Strobe Blanks for Circular Saws

Tolerance: L: +0 ~ +0.5mm, W / T : +0 ~ +0.2mm

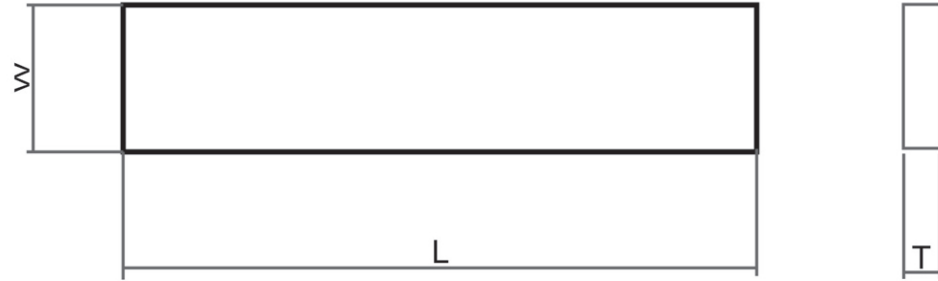

#### ISO Standard

L(mm)	W(mm)	T(mm)
25	2.5	2.0
30	3.0	2.0
	3.3	2.0
35	3.5	2.0
	3.7	2.0
40	4.0	2.0
	4.2	2.0
45	4.5	2.0
	5.0	2.0
50	5.5	2.0
60		

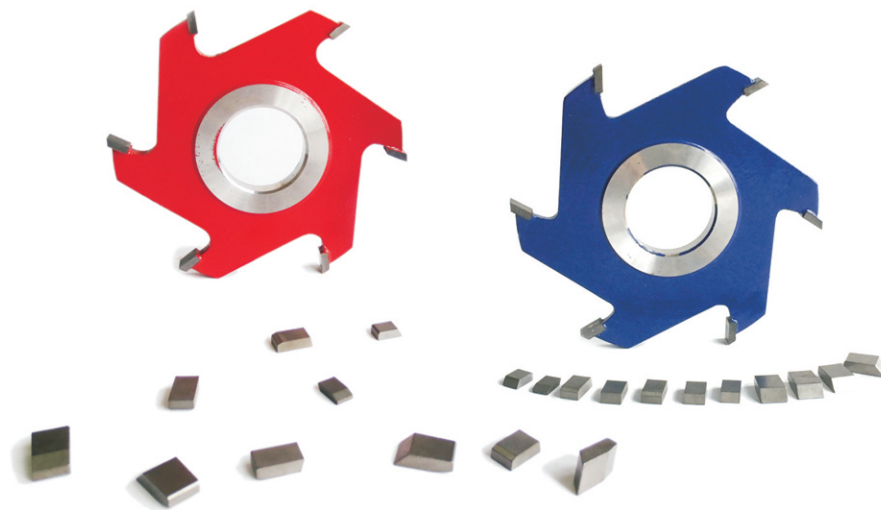

### Tungsten Carbide Woodworking Tips

Carbide wood working tips don't show in the catalogue can be produced according to drawings

W	L	K	r	T
2.7	13.0	2.0	30.0	1.0
3.0	13.0	2.0	30.0	1.0
2.3	20.0	2.0	30.0	1.0
2.7	25.0	2.0	30.0	1.0
3.7	25.0	2.0	30.0	1.0
4.0	25.0	3.0	30.0	1.1
6.5	32.0	4.5	30.0	2.0
3.0	3.0	2.5	30.0	1.1

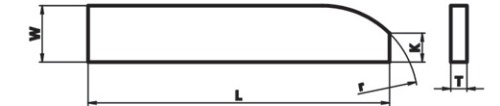

Specification (inch")	Dimensions (mm)					
	L	B	r	B2	T	R
1/4	6.35	6.85	2.7	5.5	1.5	30
5/16	8.0	6.85	4	5.2	1.5	30
3/8	9.5	8.4	4.4	6.5	1.5	30
1/2	12.7	11.6	7.6	8.7	1.8	30
5/8	16	13.2	9.1	9.8	1.8	40
3/4	19	16.3	12.3	12.5	2	50

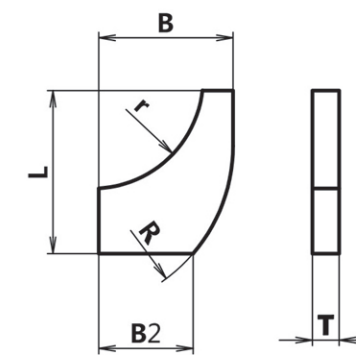

Zhuzhou Better Tungsten Carbide Co., Ltd

Tel: +86 731 28705418

Website: www.zzbetter.com

Email: sales@zzbetter.com; sales7@zzbetter.com

Skype: zzmrc

Whatsapp: +86 13647338188

Facebook: linda9638@hotmail.com